

CR1130

Manganese Dioxide
Lithium Coin Batteries

Dimensions(mm)

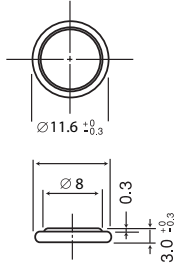

TEMPERATURE CHARACTERISTICS

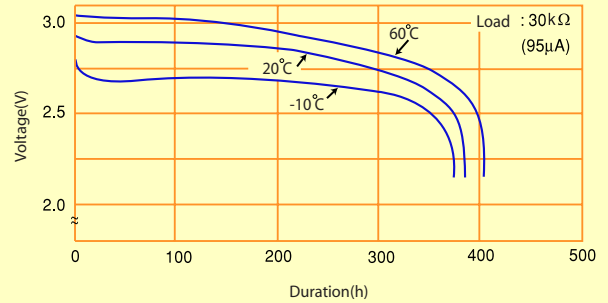

SPECIFICATION

Nominal voltage (V)	3
Nominal capacity (mAh)	40
Continuous standard load (mA)	0.05
Operating temperature (°C)	-20 ~ +70
Weight(g)	0.7

OPERATING VOLTAGE VS. LOAD RESISTANCE (voltage at 50% discharge depth)

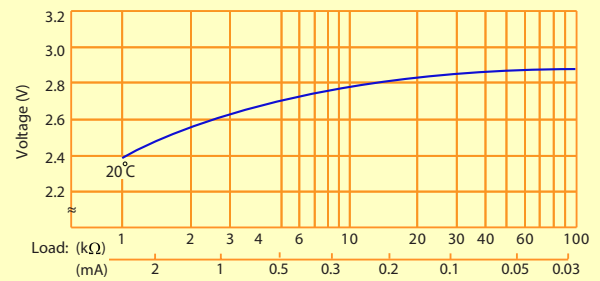

CAPACITY VS. LOAD RESISTANCE

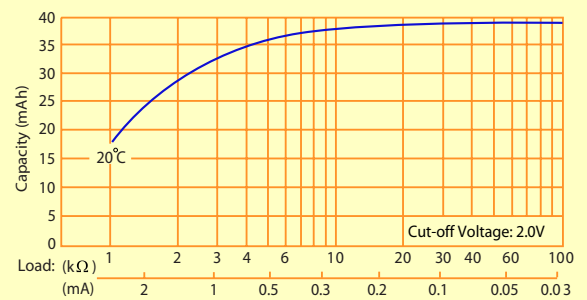

WARNING:

- Forbid short-circuit, charge between "+" and "-".
- Forbid over-discharge, fire, damage.
- Finish sealing less more 5 seconds at 200°C~250°C.
- Take out the battery when discharging to cut-off voltage, and embedding it under the ground or jump in the deep water.