

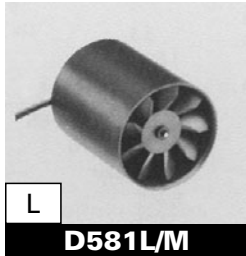

Axiallüfter
Axial Fans
Ventilateurs Axial

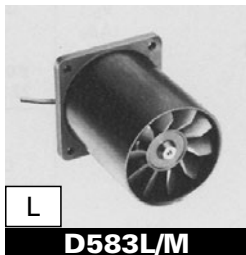

L
D581L/M

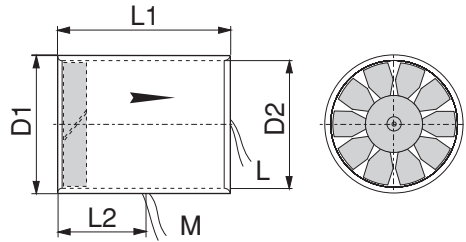

L
D583L/M

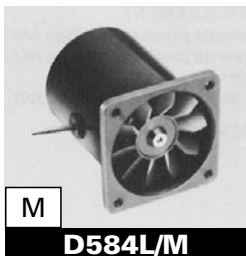
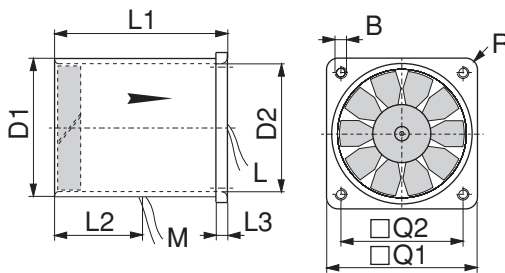

M
D584L/M

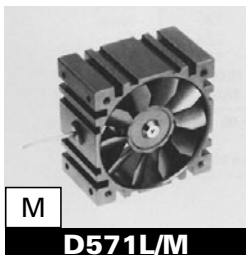
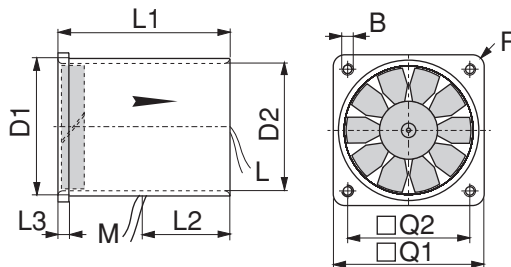

M
D571L/M

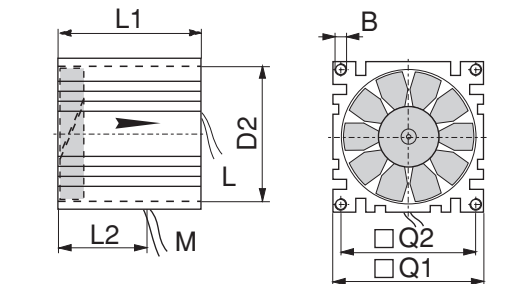

D571, 581, 583, 584 6 VDC

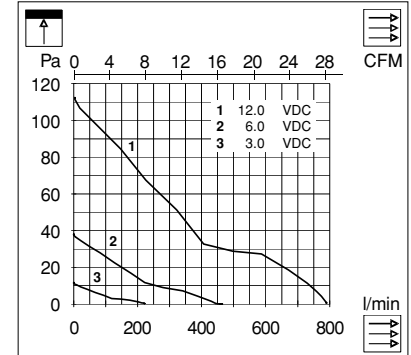

D571, 581, 583, 584 12 VDC

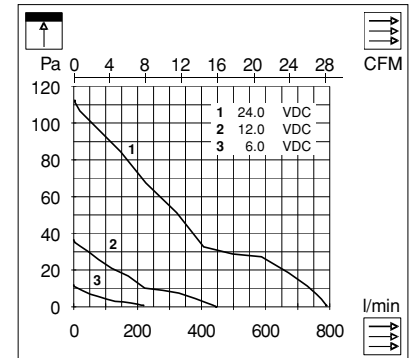

D571	mm	inch	D580	mm	inch
D1			D1	60	2.362
D2	56.5	2.224	D2	56.5	2.224
L1	36	1.417	L1	36	1.417
L2	18	0.709	L2	18	0.709
L3			L3	4	0.157
B	2.6	0.102	B	M3	
Q1	62	2.441	Q1	64	2.520
Q2	50	1.968	Q2	50	1.968
R	0.8	0.031	R	4	0.157

Technische Daten



Technical data

Caractéristiques techniques

D570/D580 Baureihen sind bei Nennspannung \square Langsam-Läufer (siehe \square). Deshalb können die Typen auch mit doppelter Spannung betrieben werden. D.h. \square = 6 V mit 12 V, \square = 12 V mit 24 V.

The series D570/D580 are at nominal voltage \square slow-running fans (see \square). These fans can be operated with double voltage (2 x \square), i.e. \square = 6 V with 12 V and \square = 12 V with 24 V.

Les séries D570/D580 à tension nominale \square sont des ventilateurs lents (voir \square). C'est pourquoi ces types peuvent être actionnés aussi à double tension (2 x \square) c'est-à-dire \square = 6 V avec 12 V et \square = 12 V avec 24 V).

Types -1  -3  -4 		D571/D581/D583/D584		D571/D581/D583/D584	
\square	U_N	V	6		12
\square	U	V	3...13.2		6...26.4
\square	I_N	mA	48 ¹	146 ²	25 ² 70 ³
\square	I_{max}	mA	60 ¹	183 ²	32 ² 88 ³
\square	I_{block}	A	0.32 ¹	0.64 ²	0.17 ² 0.34 ³
\square	P_N	W	0.29 ¹	1.75 ²	0.3 ² 1.68 ³
\square	n	min ⁻¹	3650 ¹	6600 ²	3650 ² 6600 ³
\square	\dot{V}	l/min; CFM	422/14.9 ¹	760/26.8 ²	422/14.9 ² 760/26.8 ³
\square	p	Pa	35 ¹	110 ²	35 ² 110 ³
\square	LpA	dB(A)	24 ¹	40 ²	24 ² 40 ³
\square	MTTF	hr	12 000 ¹	7 000 ²	12 000 ² 7 000 ³
\square	T	°C/F	-20...+65 / -5...+150		-20...+65 / -5...+150
\square	m	g/oz.	80/2.82		80/2.82
\square	L/M	mm/inch	190/7.480		190/7.480
\square	PPO	UL-94V-1	• D571		• D571
\square	Aluminium		• D581/D583/D584		• D581/D583/D584
\square			•		•
\square			-		-
\square			-		-
\square			-		-
\square	Accessories		•		•
\square	Accessories		•		•

¹ Bei Betriebsspannung 6 V

¹ at working voltage 6 V

¹ à tension de service 6 V

² Bei Betriebsspannung 12 V

² at working voltage 12 V

² à tension de service 12 V

³ Bei Betriebsspannung 24 V

³ at working voltage 24 V

³ à tension de service 24 V

